

IP68 CIRCULAR CONNECTORS, PLASTIC



SP13/SP17/SP21 IP68 Threaded coupling



Material and Specification		
Product Type	Connector	Overmolded Cable Assemblies
Coupling	Threaded coupling	Threaded coupling
Shell material	Nylon66, fire resistance: V-0	PC, PVC, fire resistance: V-0 Locking nut material: anodized aluminum
Insert material	PPS max temperature 260°C, fire resistance: V-0	PPS max temperature 260°C, fire resistance: V-0
Contact material	Brass with gold plating	Brass with gold plating
Termination	SP13:solder, SP17:solder/crimp, SP21:solder/screw/crimp	
Cable outer diameter range	SP13 I:4-6.5mm SP13 II:5-8mm SP17:6-10mm SP21 I:4-5.7mm SP21 II:7-12mm	
IP rating	IP68	IP66
Mating cycle	>500	>500
Temperature range	-25°C-+85°C	-25°C-+85°C
Insulation resistance mc ²	2000	2000

IP68 CIRCULAR CONNECTORS, PLASTIC

**SP
13**

SP13 Series IP68

Cable connector

Mate with SP1311, SP1312



SP1310 / P

SP1310 / S

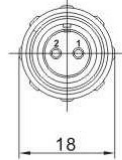

18

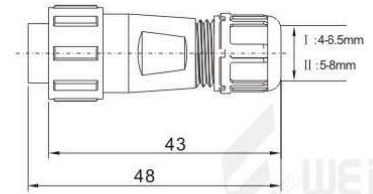

43

48

C: with cap, N: without cap

Cable outer diameter: I : 4-6.5mm , II : 5-8mm

Number of contact: 2. 3. 4. 5. 6. 7. 9

In-line cable connector

Mate with SP1310



SP1311 / P

SP1311 / S

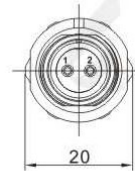

20

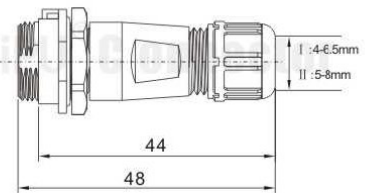

44

48

Front mount

Mate with SP1310



SP1312 / P

SP1312 / S

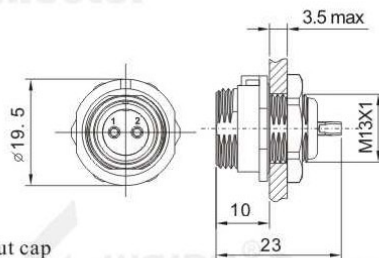

19.5

3.5 max

10

23

M3x1

● Panel cutout

12.3

13

C: with cap, N: without cap

Number of contact: 2. 3. 4. 5. 6. 7. 9

Contact arrangement and spec for solder termination

Number of contact	2	3	4	5	6	7	9
Male contact face view							
Rated current (A)	13A	13A	5A	5A	5A	5A	3A
Contact diameter	∅ 1.6X2	∅ 1.6X3	∅ 1X4	∅ 1X5	∅ 1X6	∅ 1X7	∅ 0.7X9
Rated voltage (AC.V)	250V	250V	200V	180V	125V	125V	125V
Test voltage(AC.V) 1 min	1500V	1500V	1500V	1000V	1000V	1000V	1000V
Contact resistance mΩ	2	2	5	5	5	5	10
Wire size mm ² /AWG	≤2/14	≤2/14	≤0.785/18	≤0.785/18	≤0.785/18	≤0.785/18	≤0.785/18

IP68 CIRCULAR CONNECTORS, PLASTIC

SP17 Series IP68

**SP
17**



SP1710 / P — — — — SP1710 / S

Cable connector
Mate with SP1711, SP1712

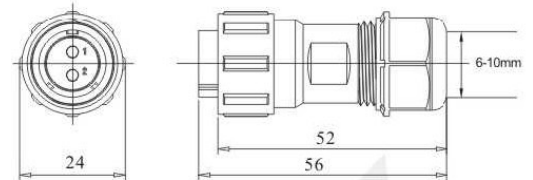

C: with cap, N: without cap
1: solder, 3: crimp
Number of contact: 2. 3. 4. 5. 7. 9. 10



SP1712 / P — — — — SP1712 / S

Front mount
Mate with SP1710

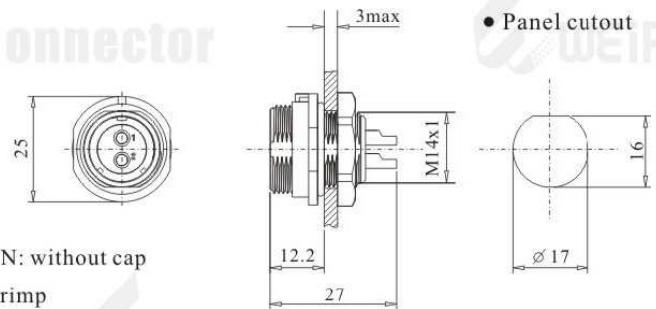

C: with cap, N: without cap
1: solder, 3: crimp
Number of contact: 2. 3. 4. 5. 7. 9. 10

Number of contact	2	3	4	5	7	9	10
Male contact face view							
Rated current (A)	10A	10A	5A	5A	5A	5A	5A
Contact diameter	∅ 1.5X2	∅ 1.5X3	∅ 1X4	∅ 1X5	∅ 1X7	∅ 1X9	∅ 1X10
Rated voltage (AC.V)	500V	500V	500V	500V	400V	400V	400V
Test voltage(AC.V) 1 min	1500V	1500V	1500V	1500V	1200V	1200V	1200V
Contact resistance mΩ	2.5	2.5	5	5	5	5	5
Wire size mm ² /AWG	≤ 2/14	≤ 2/14	≤ 0.785/18	≤ 0.785/18	≤ 0.785/18	≤ 0.785/18	≤ 0.785/18

IP68 CIRCULAR CONNECTORS, PLASTIC

SP21 Series IP68

**SP
21**



SP2110 / P — — — — SP2110 / S

Cable connector

Mate with SP2111, SP2112, SP2113

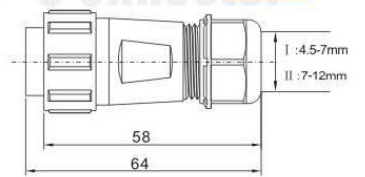

C: with cap, N: without cap

1:solder, 2:screw, 3:crimp

Cable outer diameter I : 4.5-7mm, II : 7-12 mm

Number of contact: 2.3.4.5.B.5C.7.8.9.12



SP2111 / P — — — — SP2111 / S

In-line cable connector

Mate with SP2110

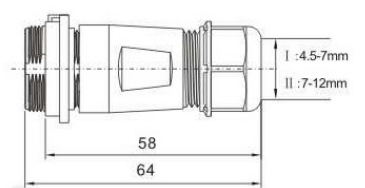
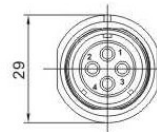

SP2112 / P — — — — SP2112 / S

Front mount

Mate with SP2110

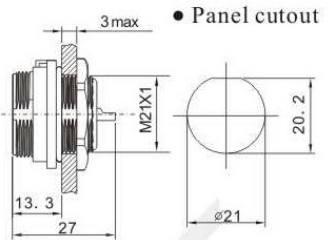
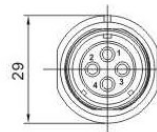

• Panel cutout



SP2113 / P — — — — SP2113 / S

2-hole flange

Mate with SP2110

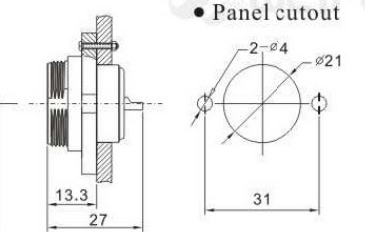
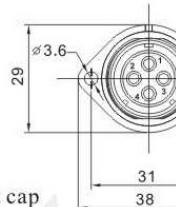

• Panel cutout

C: with cap, N: without cap

1:solder, 2:screw, 3:crimp

Number of contact: 2.3.4.5.B.5C.7.8.9.12

Number of contact	2	3	4	5	5B	5C	7	9	12
Male contact face view									
Rated current (A)	30A	30A	30A	30A	5A, 30A	15A	15A	5A	5A
Contact diameter	∅ 3X2	∅ 3X3	∅ 3X4	∅ 3X5	∅ 1X3 ∅ 3X2	∅ 2X5	∅ 2X7	∅ 1X9	∅ 1X12
Termination	solder / screw	solder / screw	solder / screw	solder / screw	solder / screw	solder	solder	solder	solder
Rated voltage (AC.V)	500V	500V	500V	500V	500V	500V	500V	500V	400V
Test voltage(AC.V) 1 min	1500V	1500V	1500V	1500V	1500V	1500V	1500V	1500V	1200V
Contact resistance mΩ	1	1	1	1	5, 1	2.5	2.5	5	5
Wire size _{mm} /AWG	≤4.17/11	≤4.17/11	≤4.17/11	≤4.17/11	≤0.785/18 ≤4.17/11	≤2/14	≤2/14	≤0.785/18	≤0.785/18